

LEGEND
 - - - - - EXISTING CONTOUR
 _____ FINISH CONTOUR

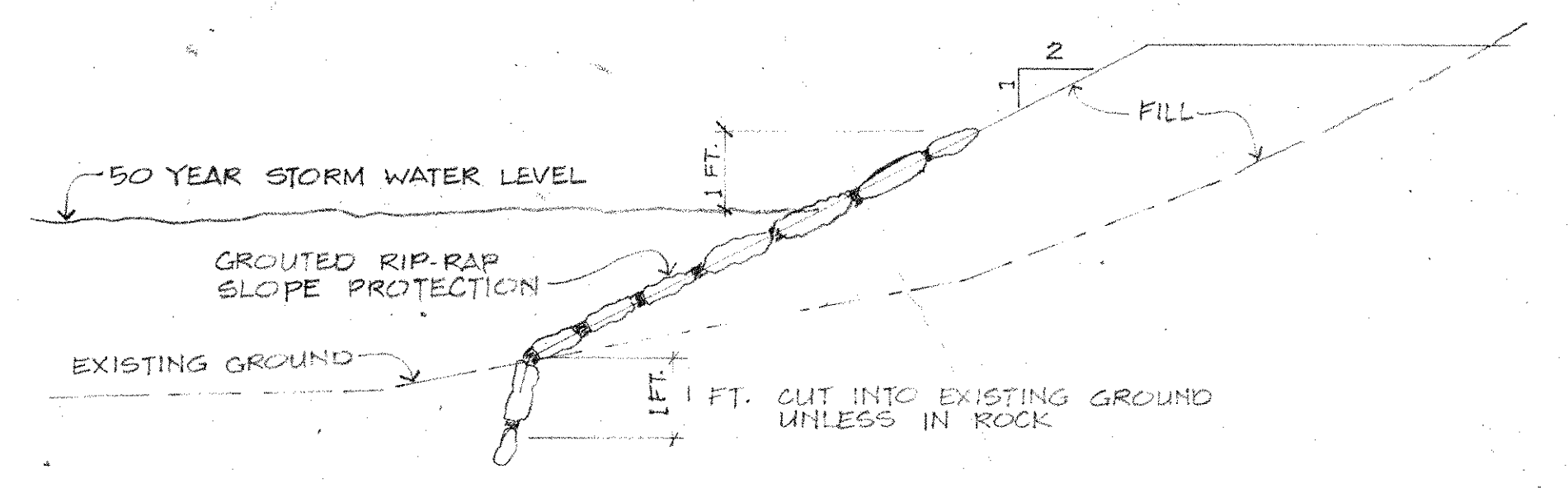

AT THE ENDS OF SLOPE PROTECTION AREAS THE GRAVELLED RIP-RAP SHALL BE EXTENDED AT RIGHT ANGLES TO THE BANK FOR A MINIMUM DISTANCE OF 2 FEET.

TYPICAL SLOPE PROTECTION ALONG GULCH
 NOT TO SCALE

DATE	DESCRIPTION	BY	CHECKED
12/15/16	ISSUED FOR PERMITS	JKP	JKP
12/15/16	REVISION 1	JKP	JKP
12/15/16	REVISION 2	JKP	JKP
12/15/16	REVISION 3	JKP	JKP
12/15/16	REVISION 4	JKP	JKP
12/15/16	REVISION 5	JKP	JKP
12/15/16	REVISION 6	JKP	JKP
12/15/16	REVISION 7	JKP	JKP
12/15/16	REVISION 8	JKP	JKP
12/15/16	REVISION 9	JKP	JKP
12/15/16	REVISION 10	JKP	JKP

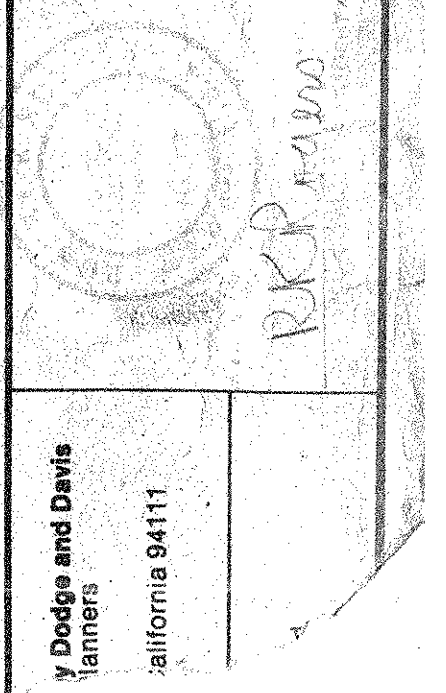

Wailea
EKAHI 2
 HAWAIIAN ENGINEERING COMPANY
 100 HOLELOA ST. HONOLULU, HAWAII 96813

TMX: 21-05-00-10-30

DATE: 12/15/16
 DRAWN: JKP
 CHECKED: JKP
 SCALE: AS SHOWN
 SHEET: 15 OF 15

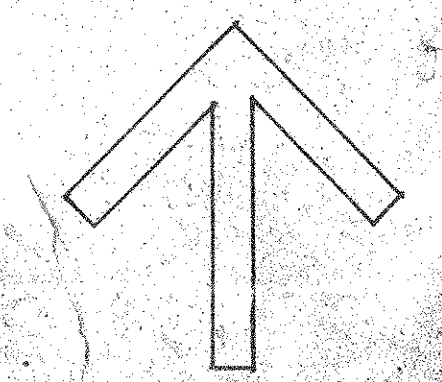



Walco

WAILEA ALANUI

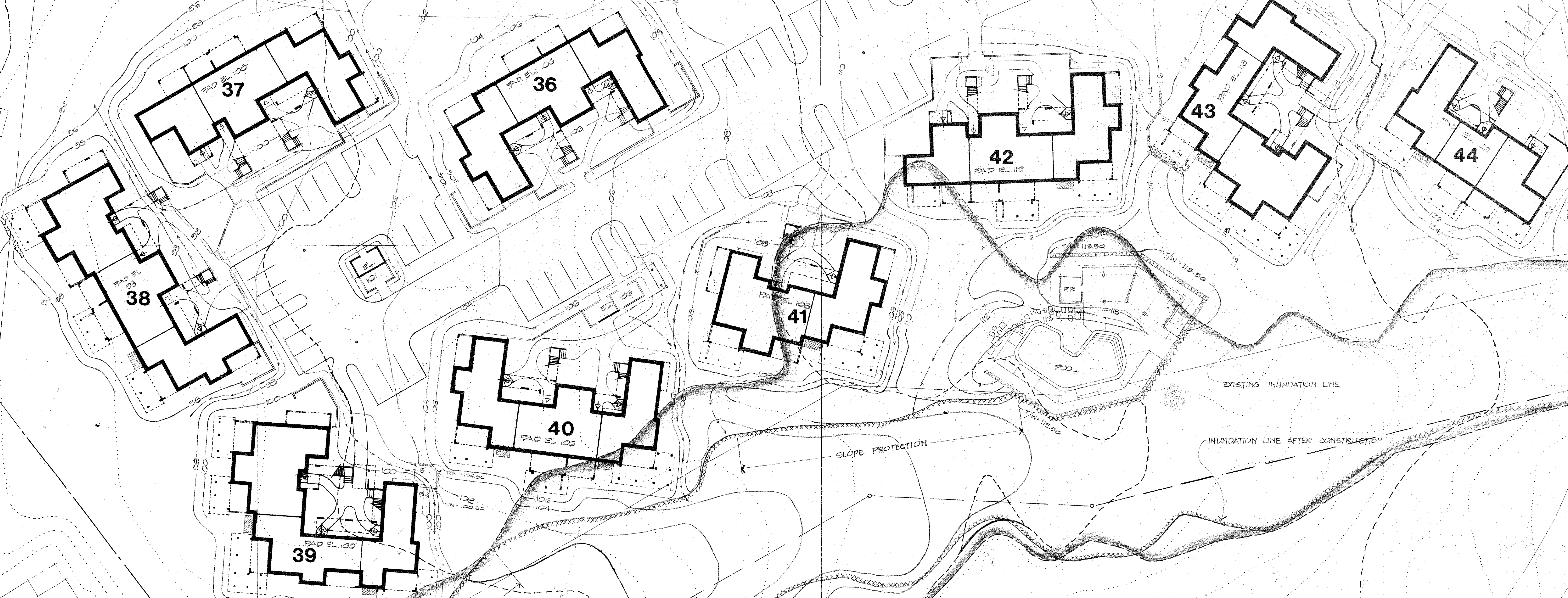

NOTE: SEE SHEET SP-G, EKAH 2 - PHASE 2 FOR "TYPICAL SLOPE PROTECTION ALONG GULCH" DETAIL.

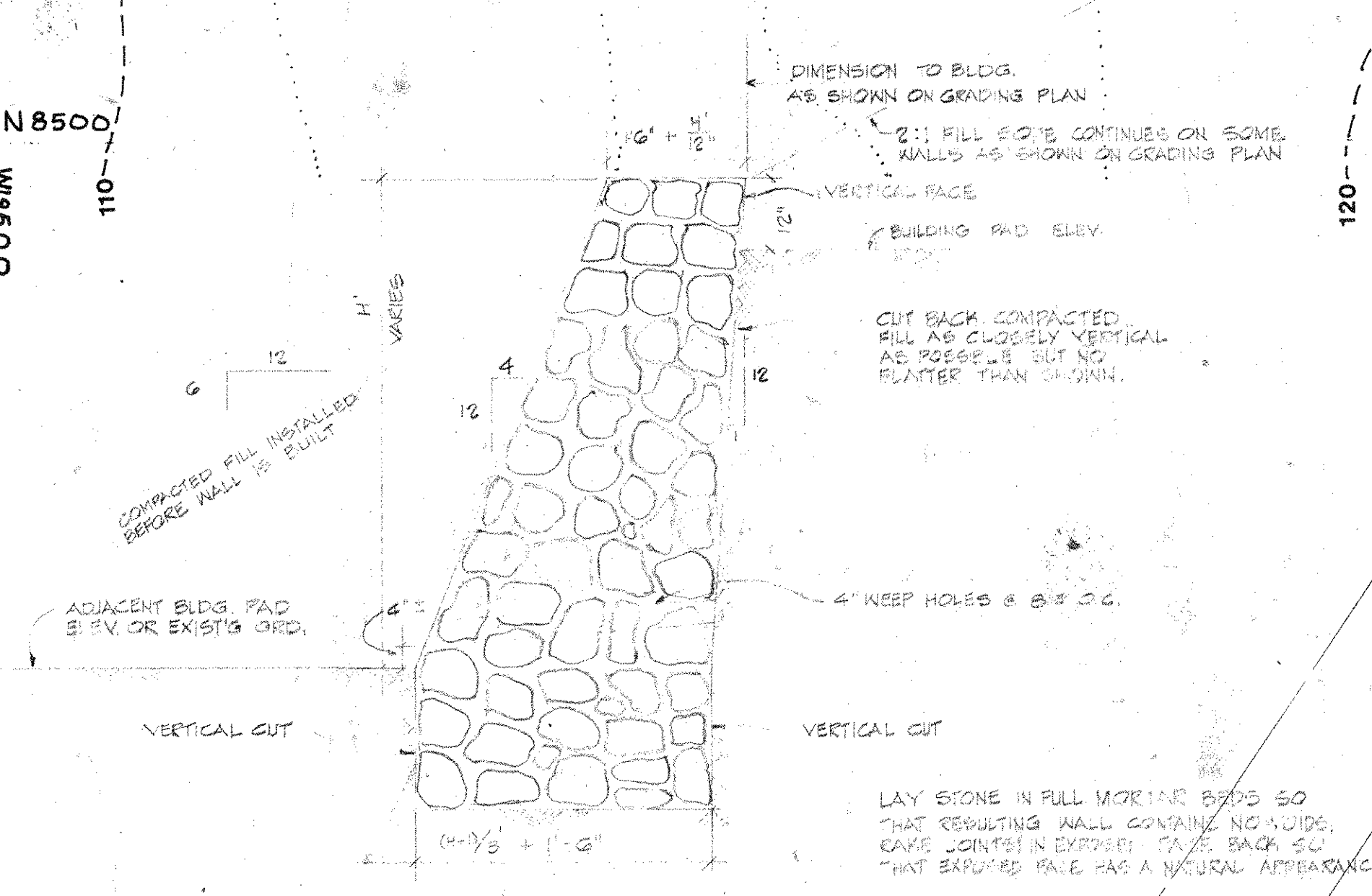

TYPICAL SECTION ROCK MASONRY WALL SCALE: 1/4" = 1'-0"

DATE	12/15/00
BY	J.M.S.
CHECKED	J.M.S.
DESIGNED	J.M.S.
PROJECT	WAILEA ALANUI
SHEET	SP-G
OF	10

Ernst & Young
 1555 Kalia Road
 Suite 1000
 Honolulu, HI 96813
 Phone: (808) 551-1000
 Fax: (808) 551-1001
 www.ey.com

Wailea
 EKAH 2
 MAUI, HAWAII

TMR 2-108-00-105

