

NOTE:  
 EXACT LOCATION OF LIGHT FIXTURES AND RECEPTACLES & UPPER POOL SHALL BE AS DIRECTED BY OWNERS ON-SITE REPRESENTATIVE EXCEPT THAT ALL DEVICES, FIXTURES, JUNCTION BOXES, ETC. SHALL BE MORE THAN 180" FROM EDGE OF POOL.

NOTE:  
 POOL CONTRACTOR SHALL INSTALL 1/2" PALM TREE LIGHTS ON POOL PALING PER DETAIL ON SHEET E-15. CONNECT TO PROPERLY ISOLATED GP PROTECTED CIRCUIT AS PART OF POOL CONTRACT.

- SYMBOLS**
- PAD FOR 1Ø PAD MOUNT M.E.C.R. TRANSFORMER
  - 9'-9" POWER HANDHOLE, M.E.C.R. STANDARD
  - 2'-4" CONCRETE POWER SERVICE BOX, M.E.C.R. STD.
  - 4'-4" TELEPHONE HANDHOLE, H.T.C.R. STANDARD
  - 2'-4" TELEPHONE PULLBOX, H.T.C.R. STANDARD
  - 2'-4" TV PULLBOX
  - MARKER BOX WITH 1/2" SHANKS @ 15' HORIZ. (50' H. SPOT) APPROXIMATE LOCATION - MAY BE RELOCATED 10' IN ANY DIRECTION - SEE DETAIL, SHT. E-15
  - PATHWAY LIGHT (4400' ALLOWANCE FOR LIGHT, POLE & BASE)
  - STREET LIGHT - STERNER BETHEL #250 (15" W. LUCULON) H/CONVESS 15" STEEL POLE IN DURANGOIC #313 FOR 240V
  - CONCRETE ENGAGED DUCT BANK (PWR, TEL, TV)
  - LANDSCAPE LIGHTING CONDUIT 1/2" x 1/2" x 1/2" GND.
  - PL PATHWAY OR GARDEN LIGHTING CONDUIT 1/2" x 1/2" x 1/2" GND.
  - SL STREET OR PARKING LIGHTING CONDUIT 1/2" x 1/2" x 1/2" GND.
  - HOME RUN TO HOUSE PANEL AT NEAREST SERVICE ENTRANCE
  - GARDEN LIGHT (475' ALLOWANCE FOR FIXTURE, POLE & BASE)
  - ADDRESS LIGHT TYPE 'L' - SEE PIAT. SCHED. SHT. E-11
  - SHADE 504-25 ON TREE - SEE DETAIL, SHT. E-15
  - DUPLEX RECEPTACLE (WEATHERPROOF)
- NOTES:**
1. THE ELECTRICAL CONTRACTOR SHALL PROVIDE A 1" SCHED. 40 E.C. CONDUIT TO BULL HIRE BETWEEN BLDGS. FOR A FUTURE SECURITY & COMMUNICATIONS SYSTEM. THE CONDUIT SHALL EXTEND FROM BLDG. TO BLDG. AND SHALL TERMINATE AT THE SECURITY CABINET AT THE ELECT. SERVICE ENTRANCE AREA. IT MAY BE ROUTED IN ANY MANNER CONVENIENT TO THE CONTRACTOR SO LONG AS THERE IS CAPABILITY TO ELECTRICALLY INTERCONNECT EACH AND EVERY BLDG. THE CONDUIT SHALL BE DIRECT BURIED IN 12" OF NORMAL BACKFILL.
  2. ALL LANDSCAPE & PATHWAY LIGHTING CONDUITS SHALL BE SCHED. 40 PVC AND SHALL HAVE A MINIMUM COVER OF 12" NORMAL BACKFILL.

**DUCT SCHEDULE**

DUCT SECTION	CONCRETE ENGAGED CONDUITS	DIRECT BURIAL CONDUITS
A	1-2" PWR 1-2" TEL 1-2" TV	1-3" PWR 1-1" TV 1-2" TEL
B	2-2" PWR	1-3" PWR 1-2" TEL 1-1" TV
C		1-3" PWR 1-2" TEL 1-1" TV
D		1-3" PWR 1-2" TEL 1-1" TV
E		1-3" PWR 1-2" TEL 1-1" TV
F		1-3" PWR 1-2" TEL 1-1" TV
G		1-3" PWR 1-2" TEL 1-1" TV
H		1-3" PWR 1-2" TEL 1-1" TV

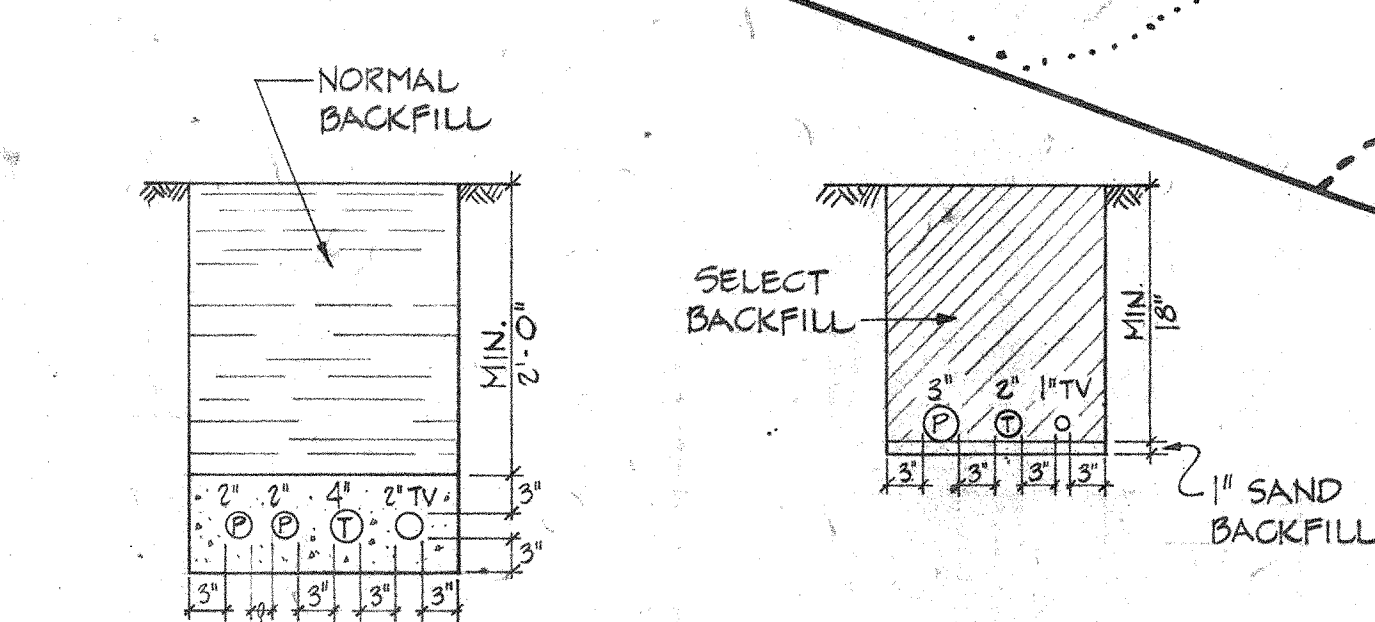

**TYPICAL DUCT SECTIONS**  
 N.T.S.

CONDUITS FOR DIRECT BURIAL, ABS DB  
 CONDUITS FOR CONCRETE ENGAGEMENT, ABS

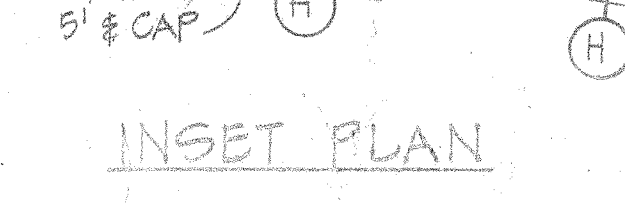

**INSET PLAN**  
 SCALE: 1" = 50'-0"

**SITE PLAN**

SCALE: 1" = 50'-0"

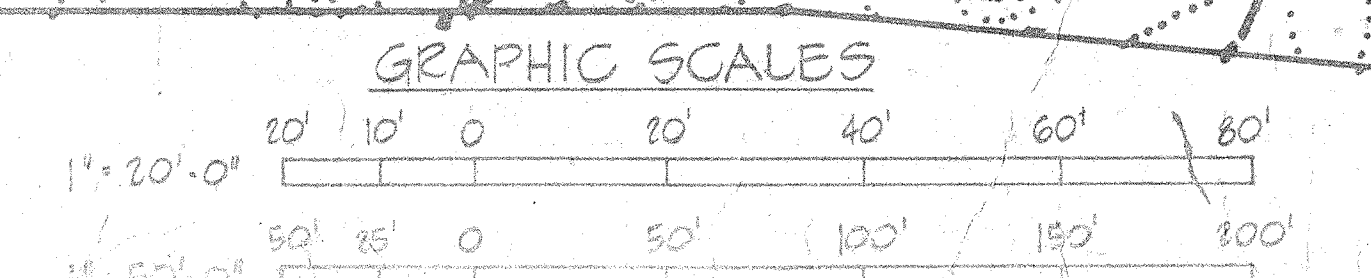

**GRAPHIC SCALES**



DATE	DESCRIPTION
1/17/20	CONSTRUCTION
1/17/20	REVISION
1/17/20	REVISION

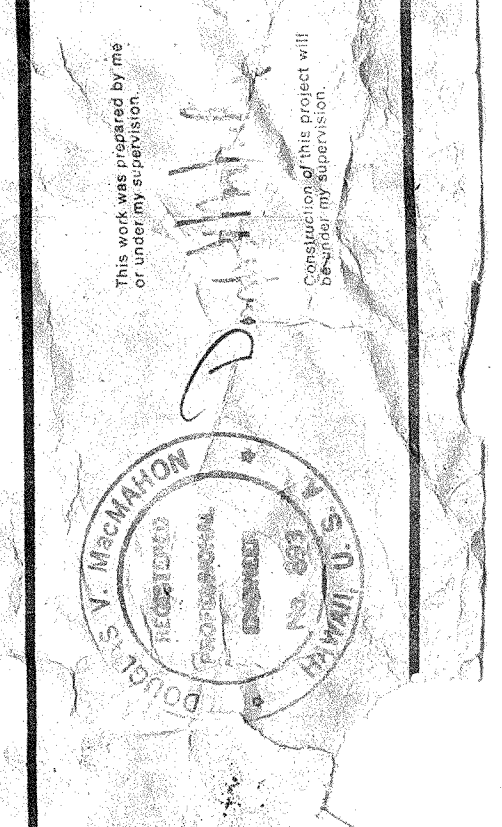

Douglas V. Haskelton, Lic.  
 11171 License  
 1311 Koaehale Avenue  
 Honolulu, Hawaii 96813

Edward Herring Dodge and Davis  
 120 Green Street  
 Honolulu, Hawaii 96813  
 Architect/Engineer  
 License No. 11171  
 Hawaii, Hawaii 96813

**Wailea**  
**EKAHI 2**  
 WAILEA, HAWAII  
 300 W. WAIKOLE ST., WAILUA, HAWAII 96738

TAX: 2-1-08-00 Lot 39  
 ELECTRICAL  
 DISTRIBUTION  
 PLAN  
 QUADRANT II  
 SCALE: 1/4" = 1'-0"  
 SHEET: 02P-17





NOTE: ELECT. CONTRACTOR SHALL VERIFY LOCATION OF OTHER SITE UTILITIES & SHALL RELOCATE ANY ELECTRICAL SITE UTILITIES AS REQUIRED TO AVOID CONFLICTS. THE CONTRACTOR SHALL NOTIFY THE OWNERS OF SITE REPRESENTATIVE PRIOR TO MAKING ANY SUCH RELOCATIONS.

DUCT SCHEDULE		
DUCT SECTION	CONCRETE ENCASED CONDUITS	DIRECT BURIAL CONDUITS
A	1-2" PWR. 1-2" TEL. 1-2" TV	
B	2-2" PWR.	
C	2-2" PWR. 1-4" TEL. 1-2" TV	
D	2-2" PWR. 1-2" TEL. 1-2" TV	
E	2-2" PWR. 2-2" TEL. @ 500 MCM AL EA. 1-2" TV	
F		1-3" PWR., 1-2" TEL. @ 1" TV
* G		2-3" C-3 # 500 MCM AL EA.
* H		2-3" C-3 # 350 MCM AL EA.
* I		2-3" C-3 # 400 MCM AL EA.
* J		2-3" C-3 # 500 MCM AL EA.
* K		2-3" C-3 # 200 MCM AL EA.
* L		1-4" C-3 # 750 MCM AL EA.
* M		2-4" C-3 # 750 MCM AL EA.
N		3/4" C-3 # 6 CU
O		1" C-3 # 6 CU @ 1/2" CU GND.

**SYMBOLS**

- PAD FOR 10 PAD MOUNT M.E.CO. TRANSFORMER
- 3/4" POWER HANDHOLE, M.E.CO. STANDARD
- 2" CONCRETE POWER SERVICE BOX, M.E.CO. STANDARD
- 2" TELEPHONE HANDHOLE, H.T.CO. STANDARD
- 2" TELEPHONE PULLBOX, H.T.CO. STANDARD
- 2" TV PULLBOX
- CONC. ENCASED OR DIRECT BURIAL DUCT BANK - SEE SCHEDULE, THIS SHT.
- STREET OR PARKING LIGHTING CONDUIT 1" @ 2" @ 1" @ 1" GND.
- PATHWAY OR GARDEN LIGHTING CONDUIT 1" @ 2" @ 1" @ 1" GND.
- LANDSCAPE LIGHTING CONDUIT 1" @ 2" @ 1" @ 1" GND.
- HOMERUN TO HOUSE PANEL AT NEAREST SERVICE ENTRANCE
- STREET LIGHT - STERNER BETHEL #30 (150W LOCAL) FOR 120V (V.CAT. #RTA-04-20 ROUND TAPERED ALUM. POLE DURANGO #313
- PATHWAY LIGHT - STERNER BETHEL #100 (100W LOCAL) FOR 120V (V.CAT. #RTA-016-10 ROUND TAPERED ALUM. POLE DURANGO #313
- MARM. RE. BOX W/ 2 SHALDA #304 15 W/ 20 COED (150W SPOT) APPROXIMATE LOCATION - MAY BE RELOCATED 20' IN ANY DIRECTION - SEE DETAIL, SHT. E-14
- GARDEN LIGHT (\$ 20.00 ALLOWANCE FOR FIXTURE, POLE & BASE)
- ADDRESS LIGHT TYPE 'L' - SEE FIXTURE SCHEDULE, SHT. E-12
- GARBAGE ENCL. LIGHT TYPE 'N' - REFER TO SHT. E-7 FOR EXACT LOC. & SHT. E-12 FOR DESCRIPTION IN FIXT. SCHED.
- GARBAGE ENCL. EXTERIOR LIGHT - 10" @ 2" DIA. VANDAL-PROOF W/ HOOD LIGHT TOWER #G150 W/ 150W I.F. 150V LAMP
- TELLER'S LIGHT TYPE 'OO' - SEE FIXTURE SCHEDULE, SHT. E-12 & DETAIL (A) ON SHT. E-3.
- HOMERUN TO NEAREST LIGHT @ STAIRS

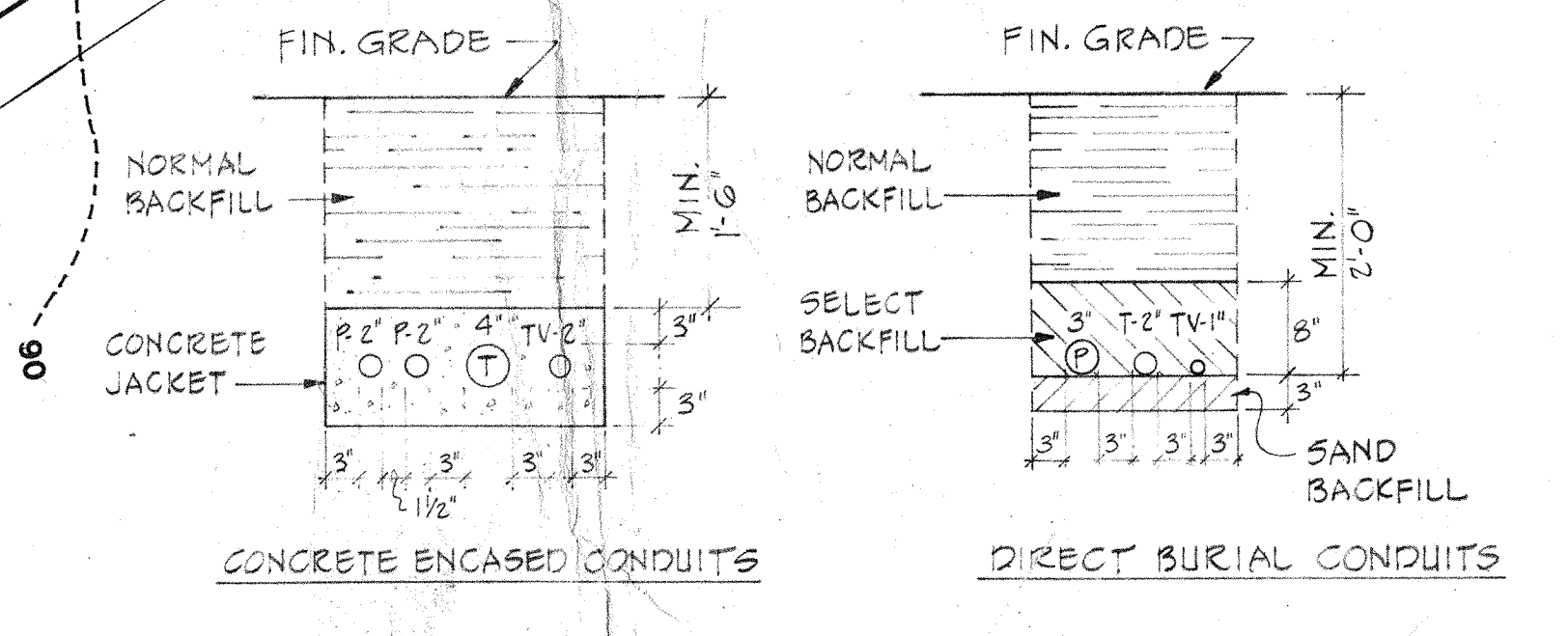

TYPICAL DUCT SECTIONS  
N.T.S.  
CONDUITS FOR DIRECT BURIAL ASS 'OB'  
CONDUITS FOR CONC. ENCASEMENT ASS 'EB'

NOTE: IF CONDUIT IS NOT DESIGNATED BY DUCT SECTION TYPE (A) OR OTHERWISE (-9L-), IT IS 3/4" @ 2" @ 1" @ 1" GND.

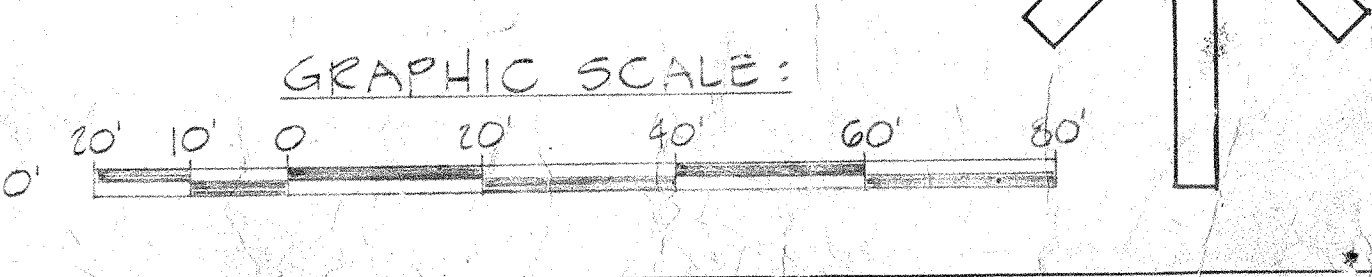

**Wailea EKAH2**  
 WAILEA DEVELOPMENT COMPANY  
 825 BRIDGE ST. HAWAII, HAWAII 96706  
 TEL: 808-935-1111  
 FAX: 808-935-1112  
 WWW.WAILEADEV.COM

ENGINEER: M. M. M. M.  
 1333 KALANANAKU AVE.  
 HONOLULU, HI 96813  
 (808) 935-2500

PROJECT NO. 2010-001  
 SHEET NO. SP-14

DATE: 11-10-10  
 SCALE: 1" = 20'